

Smart Diagnosis

This function provides comprehensive diagnosis results on the selected vehicle's system. You can check various functions such as the presence/non-presence of fault codes, ECU upgrade target status and ECU mapping check, etc. at once.

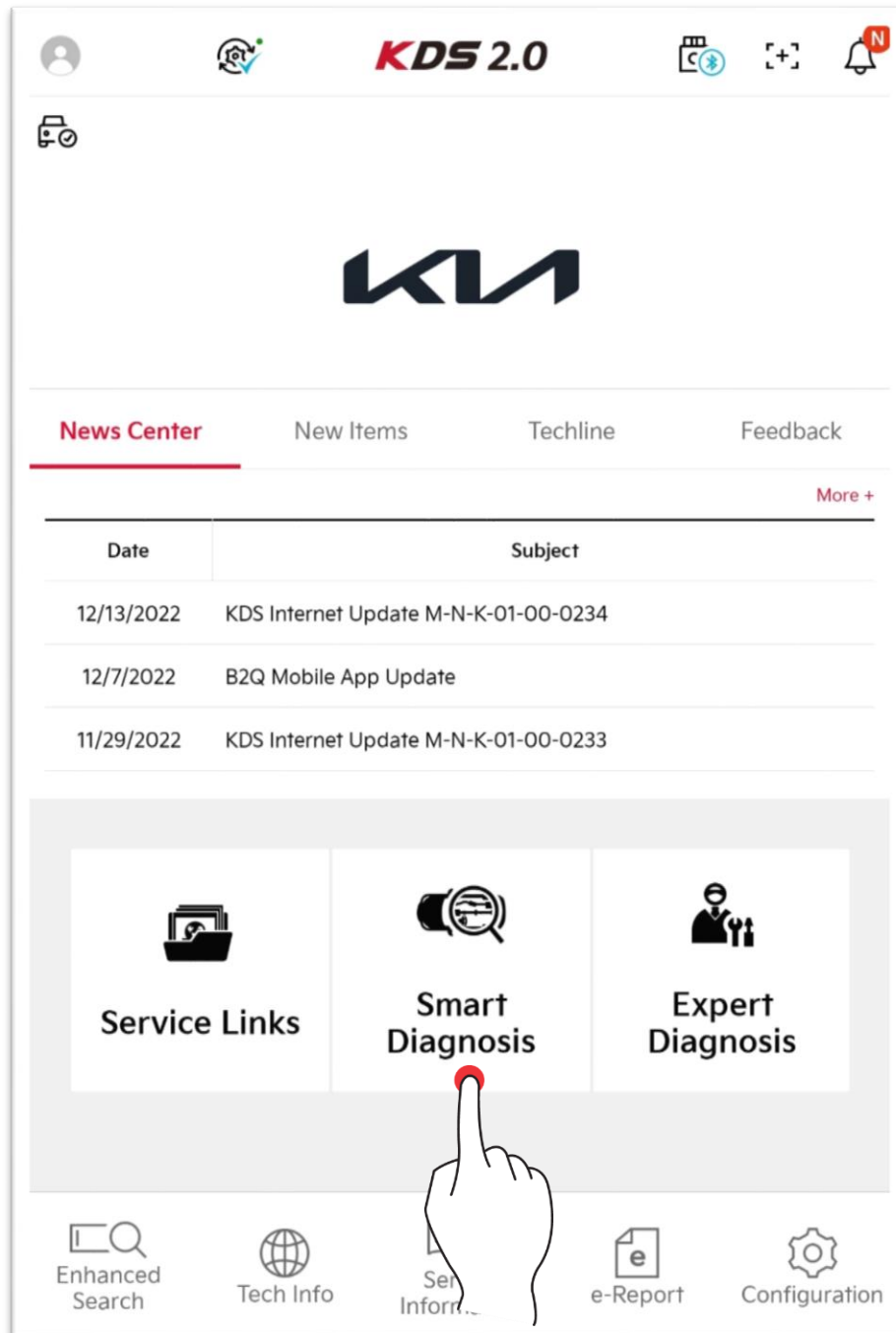

Screen Configuration

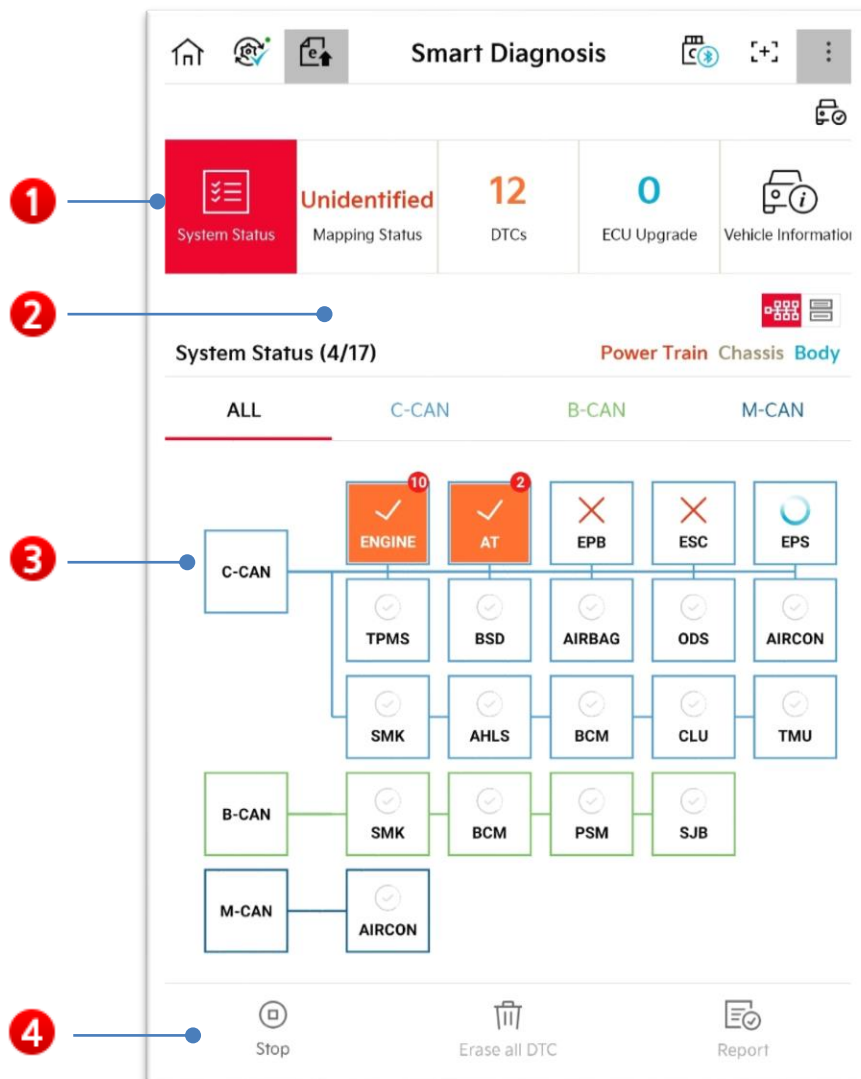

1	It briefly shows the selected vehicle type/system's number of fault codes, number of ECU upgrade targets, mapping status and vehicle information. If you select an item, you will be provided with a link to the corresponding function.
2	You can select a mode for showing the diagnosis results of the system. It is provided as icon type (CAN topology type) and list type.
3	It shows the progress of diagnosis communication, as well as number of fault codes per system and ECU upgrade targets.
4	You can Stop or delete fault codes. The result report can be saved as a PDF file or printed.

Top Menu - ECU Mapping Status

It shows results on mapping status through comparison of CVN values of the controller.

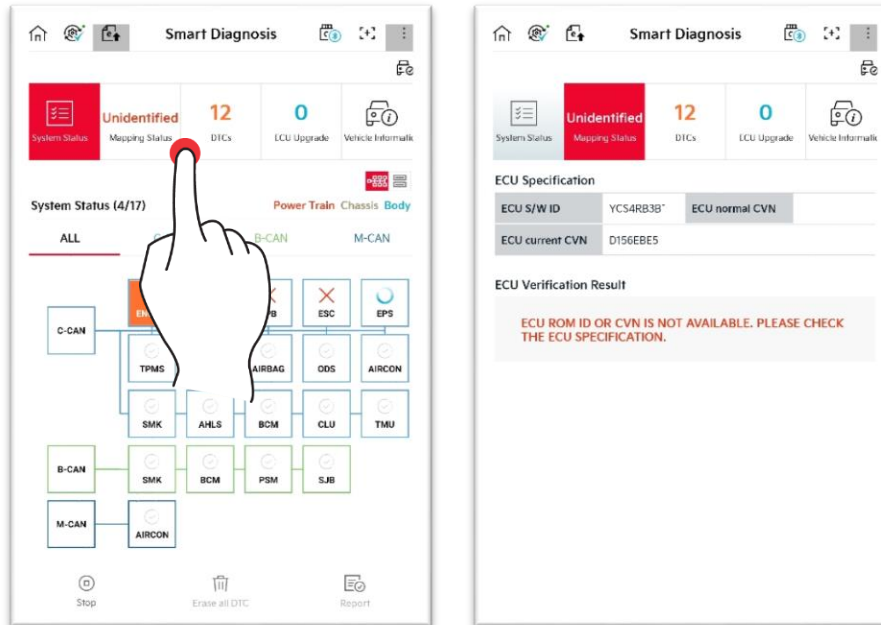

Good	Vehicle's CVN is normal
Bad	Vehicle has a different CVN from the server
Unidentified	Unable to read vehicle's CVN

Top Menu - Fault Code

It shows a list of fault codes that are searched.

For detailed information, please refer to 'Fault Code Diagnosis' guide.

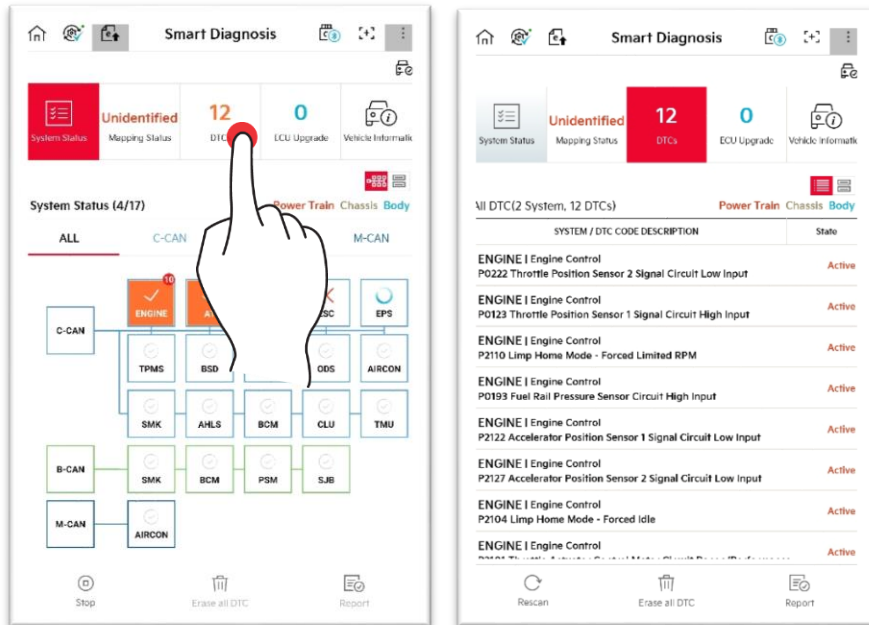

Top Menu - ECU Upgrade

You can check the list of ECU upgrades that are searched.

When you select ECU upgrade item, it is linked to ECU upgrade function.

For detailed information, please refer to 'ECU Upgrade' guide.

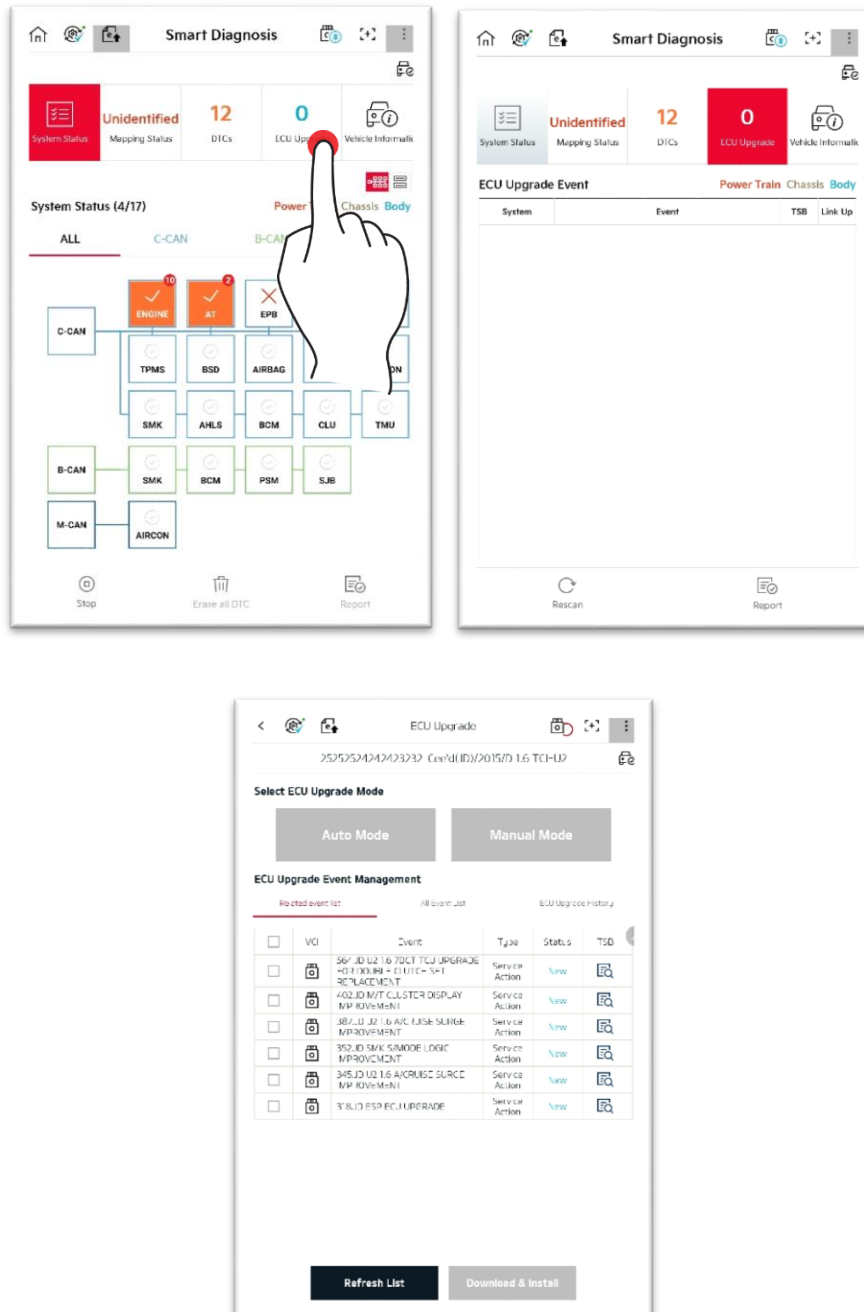

Top Menu - Vehicle Information

It provides information of vehicle and warranty repair history, etc.

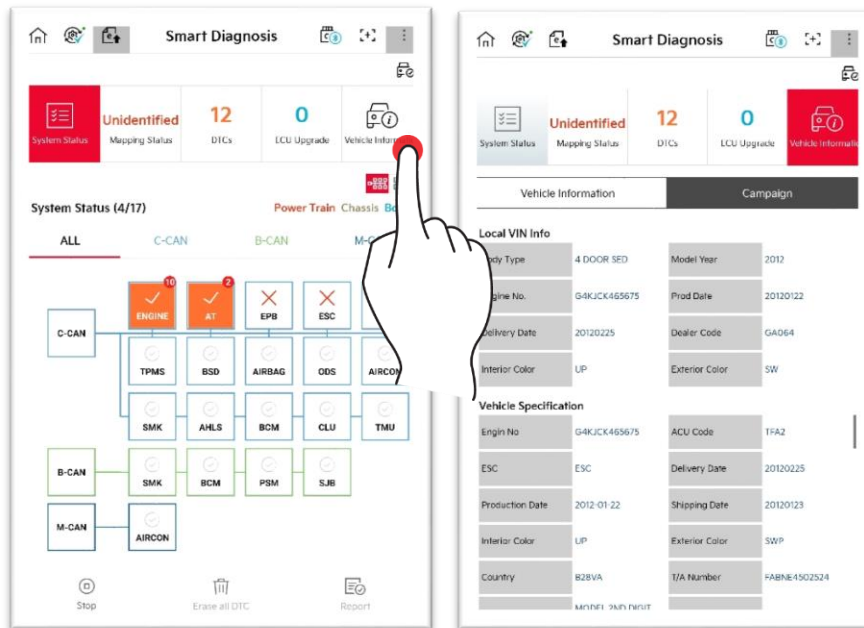

Diagnosis Results

Diagnosis communication process and results are provided as icon type (CAN topology) and list type.

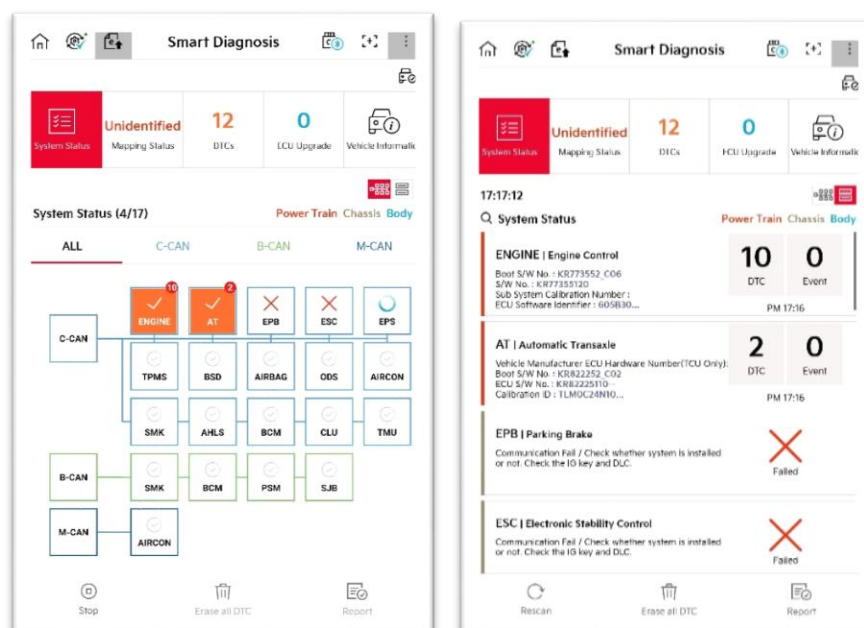

Icon Type (CAN Topology)

It shows diagnosis communication process and results as icon type.
You can check it for each CAN line.

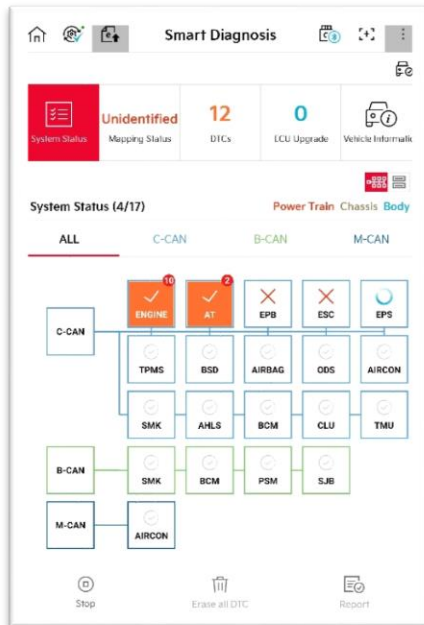

<ALL>

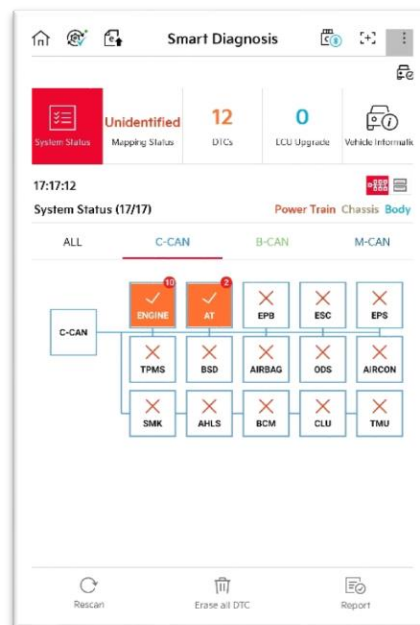

<C-CAN>

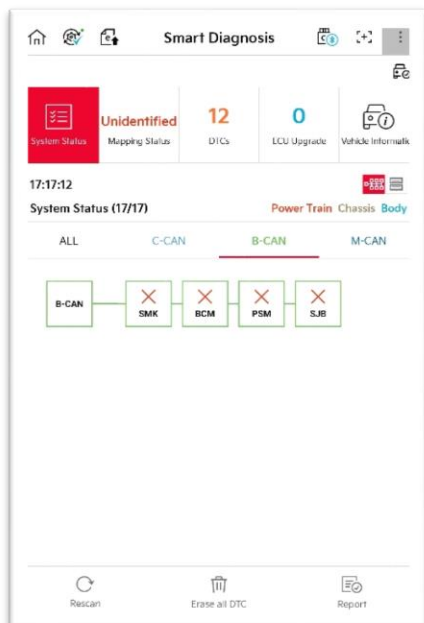

<B-CAN>

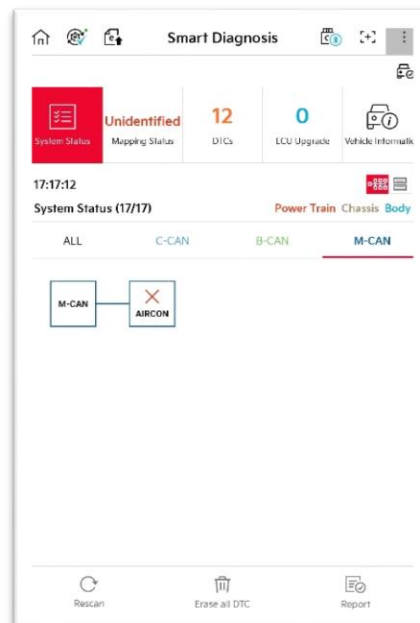

<M-CAN>

A detailed screen appears when you select the system.
It provides information on fault codes, ECU upgrade list and system specification.
If you touch 'More +', it provides a link to a relevant function.

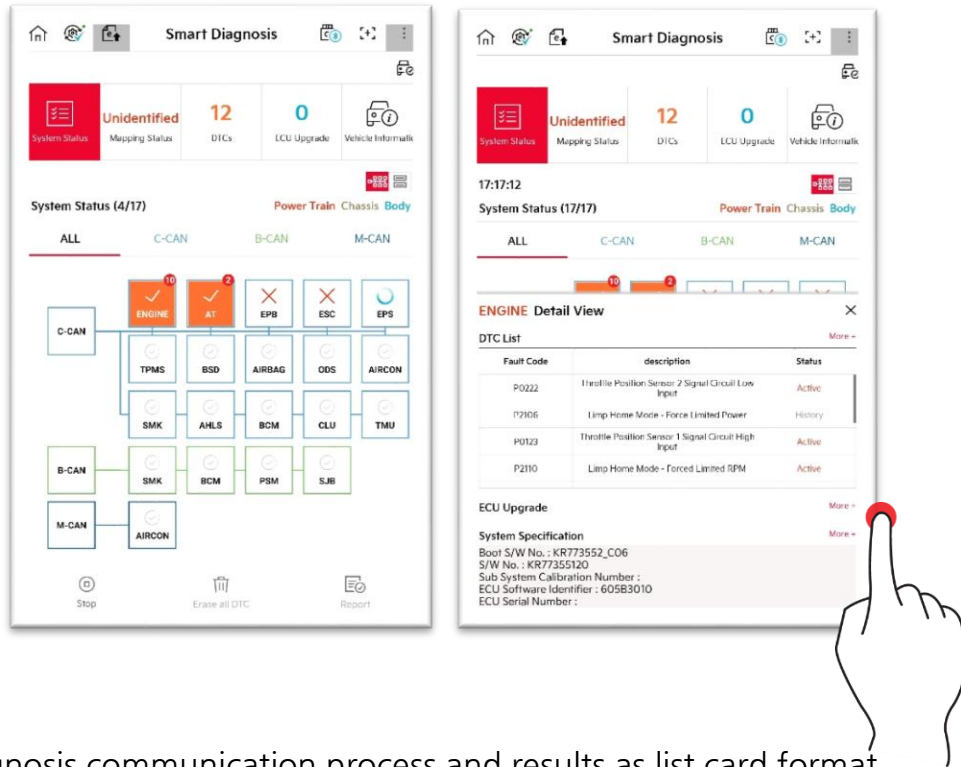

List Type

It shows diagnosis communication process and results as list card format.
It shows information on fault codes, ECU upgrade list and system specification.
If you touch DTC and ECU, it provides links to relevant functions.

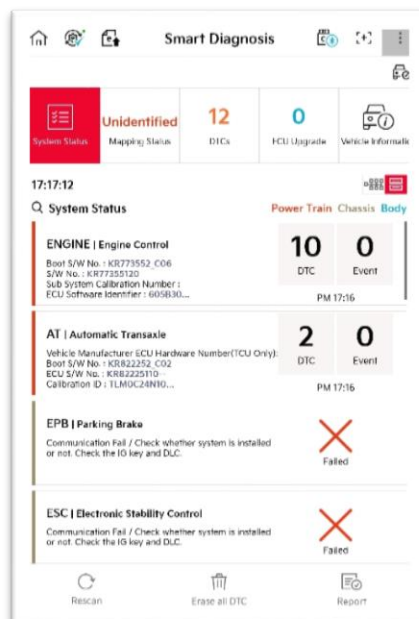

Re-search/Delete the Entire Fault Codes

It provides function of re-search on the selected system, as well as fault code delete function for the fault codes that are found.

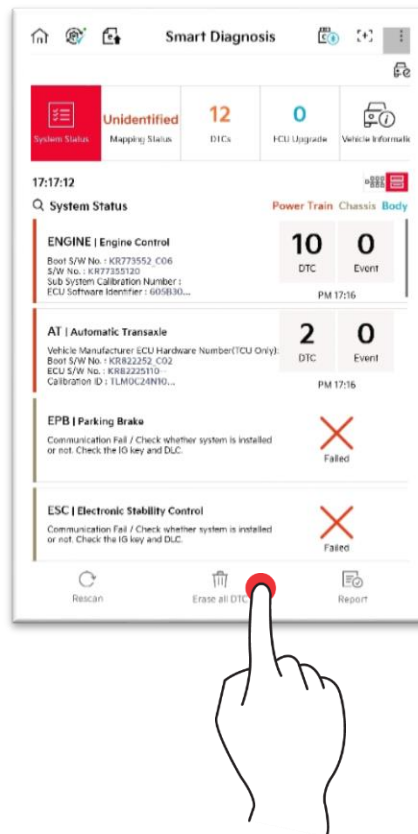

Smart Diagnosis Report

Provides the function to save or print the result report as a PDF file.

