

S/W Management

- High Voltage Battery Pack Connector Check

After the high voltage battery pack partial repair, the connection status of connectors (CMU, sub-module, BUS bar, temperature sensor) can be checked through the S/W Management.

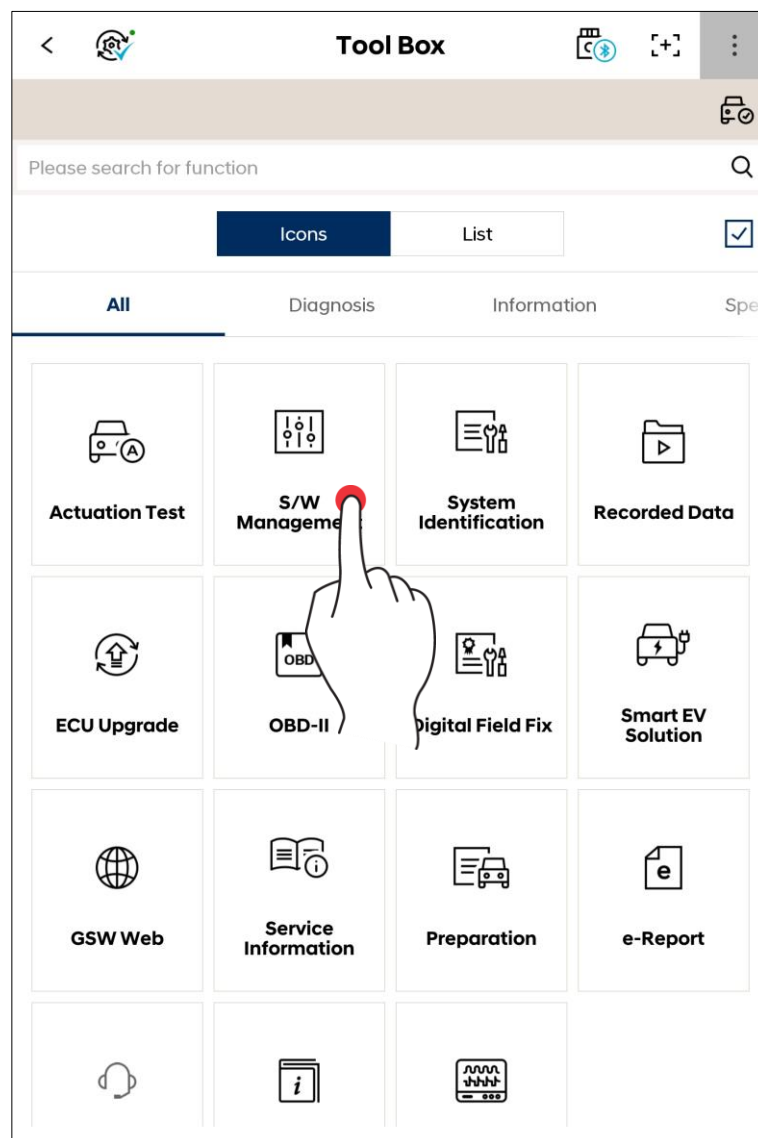

1. Please select the 'High voltage battery pack connector check' on S/W Management.

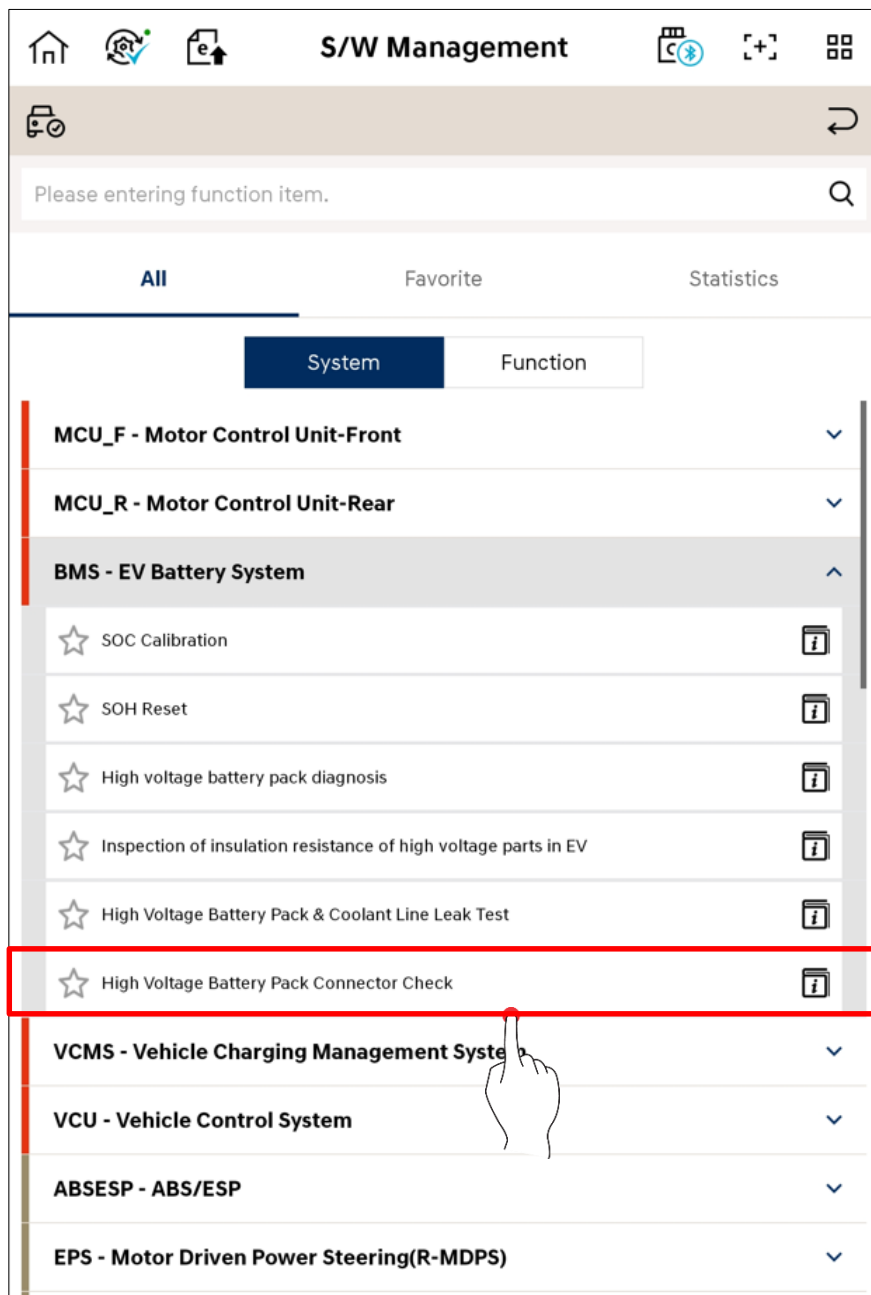

2. Refer to the connection notice and connect the device to the vehicle.

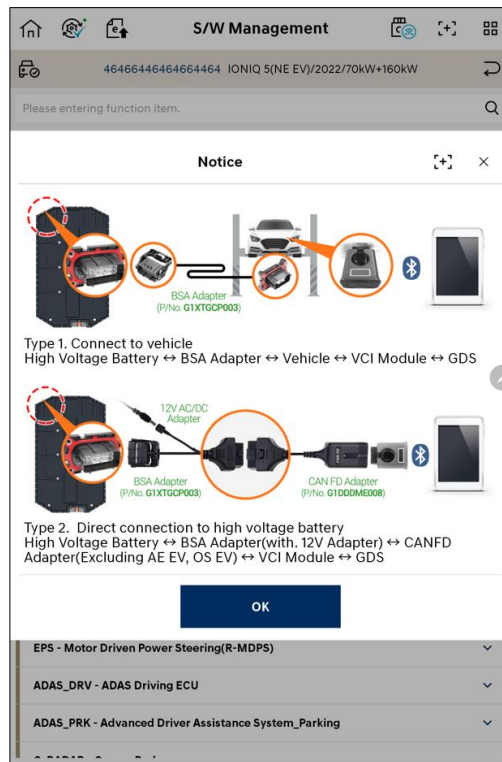

3. After checking the inspection purpose and conditions, press the 'OK' button.

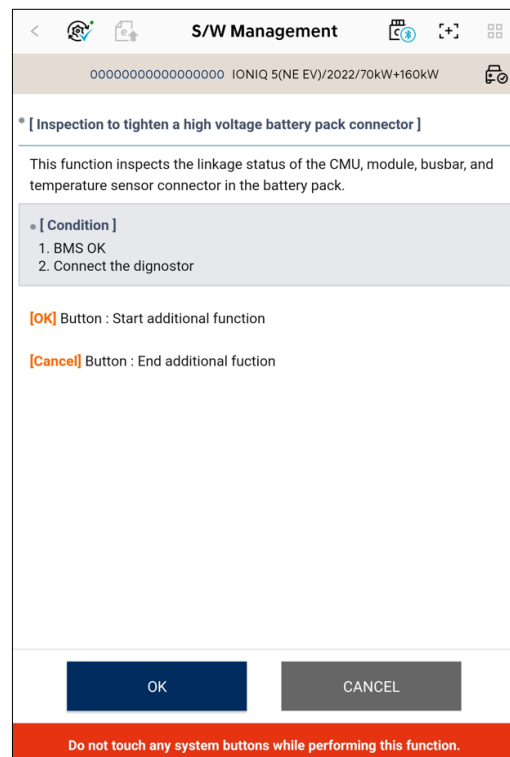
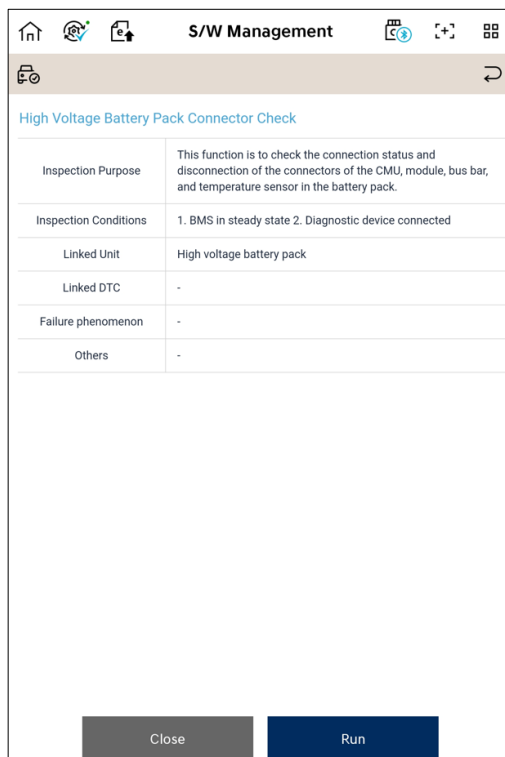

4. After confirming the inspection order, press the 'OK' button.

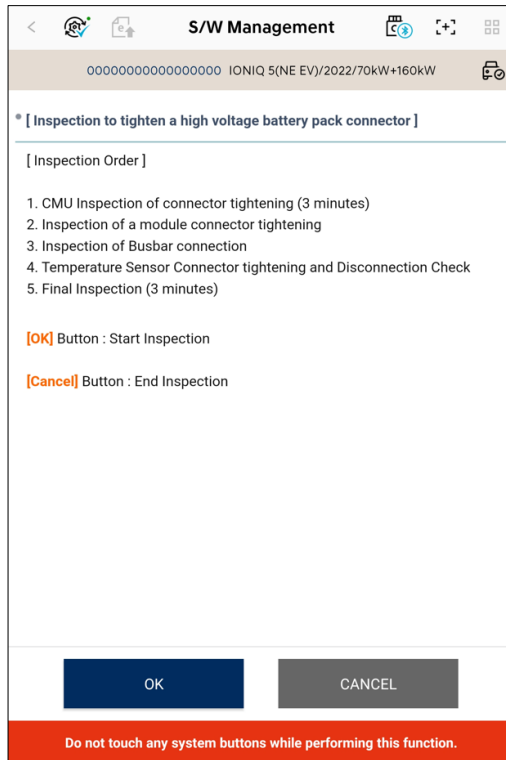

5. Proceed with CMU connector inspection.

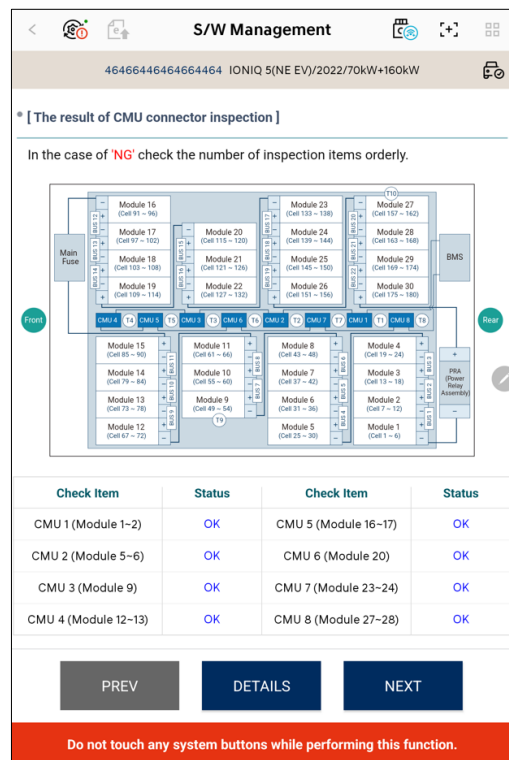
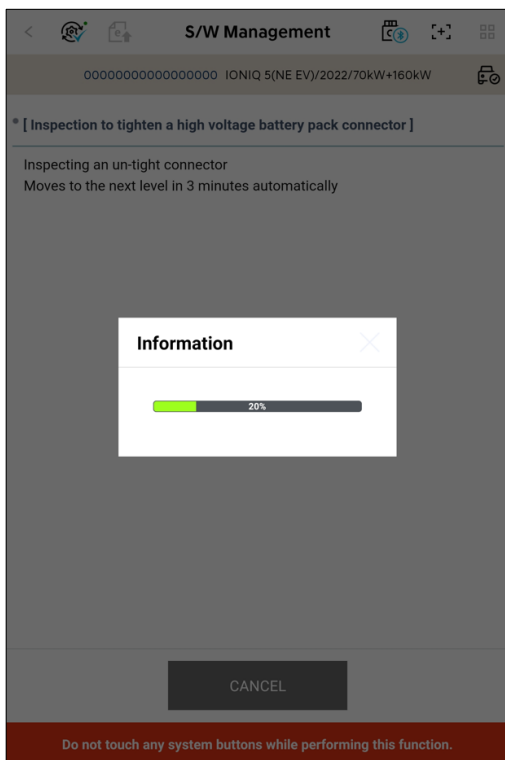



- You can check the unfastened parts through images and judgment values.
 - You cannot proceed to the next step in the 'NG' (uncontracted) state.
 - You can check the related sensor data through the 'Details' button.
- *CMU is configured for serial connection, and the sub-connector is inspected after the NG connector is checked.

S/W Management

46466446464646464646 IONIQ 5(NE EV)/2022/70kW+160kW

* [The result of CMU connector inspection]

In the case of 'NG' check the number of inspection items orderly.

Check Item	Status	Check Item	Status
CMU 1 (Module 1-2)	OK	CMU 5 (Module 16-17)	Waiting
CMU 2 (Module 5-6)	OK	CMU 6 (Module 20)	Waiting
CMU 3 (Module 9)	OK	CMU 7 (Module 23-24)	Waiting
CMU 4 (Module 12-13)	NG	CMU 8 (Module 27-28)	Waiting

PREV DETAILS NEXT

Do not touch any system buttons while performing this function.

S/W Management

0000000000000000 IONIQ 5(NE EV)/2022/70kW+160kW

Sensor Name	Value	Unit
Battery Cell Voltage 15	4.08	V
Battery Cell Voltage 16	4.08	V
Battery Cell Voltage 17	4.08	V
Battery Cell Voltage 18	4.08	V
Battery Cell Voltage 19	4.08	V
Battery Cell Voltage 20	4.08	V
Battery Cell Voltage 21	4.08	V
Battery Cell Voltage 22	4.08	V
Battery Cell Voltage 23	4.08	V
Battery Cell Voltage 24	4.08	V
Battery Cell Voltage 25	5.10	V
Battery Cell Voltage 26	5.10	V
Battery Cell Voltage 27	5.10	V
Battery Cell Voltage 28	5.10	V
Battery Cell Voltage 29	5.10	V
Battery Cell Voltage 30	5.10	V
Battery Cell Voltage 31	5.10	V

PREV

Do not touch any system buttons while performing this function.

6. Inspect the sub-module connector connection.

S/W Management

4646644646464646464 IONIQ 5(NE EV)/2022/70kW+160kW

* [The result of module connector inspection]

In the case of 'NG' check the number of inspection items orderly.

Check Item	Status	Check Item	Status
Module 1	OK	Module 16	OK
Module 2	OK	Module 17	OK
Module 3	OK	Module 18	OK
Module 4	OK	Module 19	OK

PREV DETAILS NEXT

Do not touch any system buttons while performing this function.

7. BUS bar tightening inspection is carried out.

S/W Management

4646644646464646464 IONIQ 5(NE EV)/2022/70kW+160kW

* [The result of the busbar inspection]

In the case of 'NG' check the number of inspection items orderly.

Check Item	Status	Check Item	Status
BUS Bar 1	OK	BUS Bar 12	OK
BUS Bar 2	N/A	BUS Bar 13	N/A
BUS Bar 3	OK	BUS Bar 14	OK
BUS Bar 4	OK	BUS Bar 15	N/A

PREV DETAILS NEXT

Do not touch any system buttons while performing this function.



< Reasons for not being able to inspect certain BUS bars >

- The untestable BUS bar is composed of a circuit that does not change the cell voltage, so it cannot be judged.

8. Inspect the temperature sensor connection.

* [The result of the inspection for the connector of the temperature sensor and disconnection]

When it displayed 'NG' for tightening, please check the order of the number of inspection items.

Check Item	Status	Check Item	Status
Temp.1 (T1,T2)	OK	Temp.6 (T11,T12)	OK
Temp.2 (T3,T4)	OK	Temp.7 (T13,T14)	OK
Temp.3 (T5,T6,T17)	OK	Temp.8 (T15,T16,T18)	OK

PREV DETAILS NEXT

Do not touch any system buttons while performing this function.

9. After final re-inspection of connector tightening presence/absence, the test result is displayed.

* [Inspection to tighten a high voltage battery pack connector]

In the final inspection of an un-tight connector
Completed according to the test result in 3 minutes, or move to Inspect un-tight Connectors.

Information

37%

CANCEL

Do not touch any system buttons while performing this function.

* [Inspection to tighten a high voltage battery pack connector]

In the final inspection of an un-tight connector
Completed according to the test result in 3 minutes, or move to Inspect un-tight Connectors.

Information

High Voltage Battery Pack Tightening Inspection Completed
However, an abnormality has been detected in some battery cell voltages.
Check the voltage value from the sensor data.

[OK] Button : Finish

OK

CANCEL

Do not touch any system buttons while performing this function.



- The connector connection test has been completed, but there may be an abnormality in the cell voltage. Check the cell voltage through Sensor Data diagnosis.