

## Fault Code Searching

It searches fault code(s) of one or multiple number of systems mounted on the vehicle. The users can check detailed information related to fault codes that are searched, as well as maintenance information.

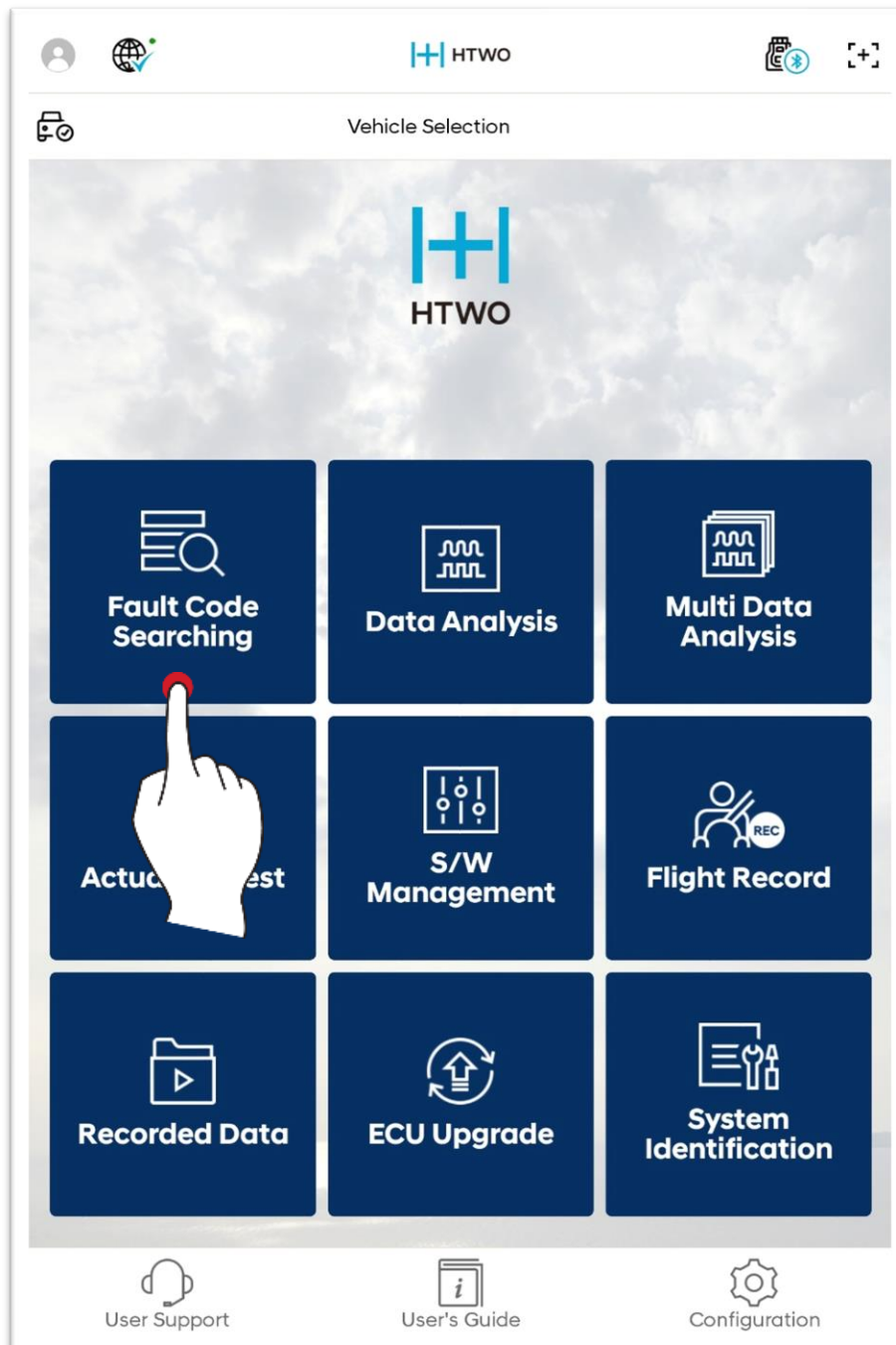

## Basic Operation

The searched fault codes can be checked in formats of group or list by system.

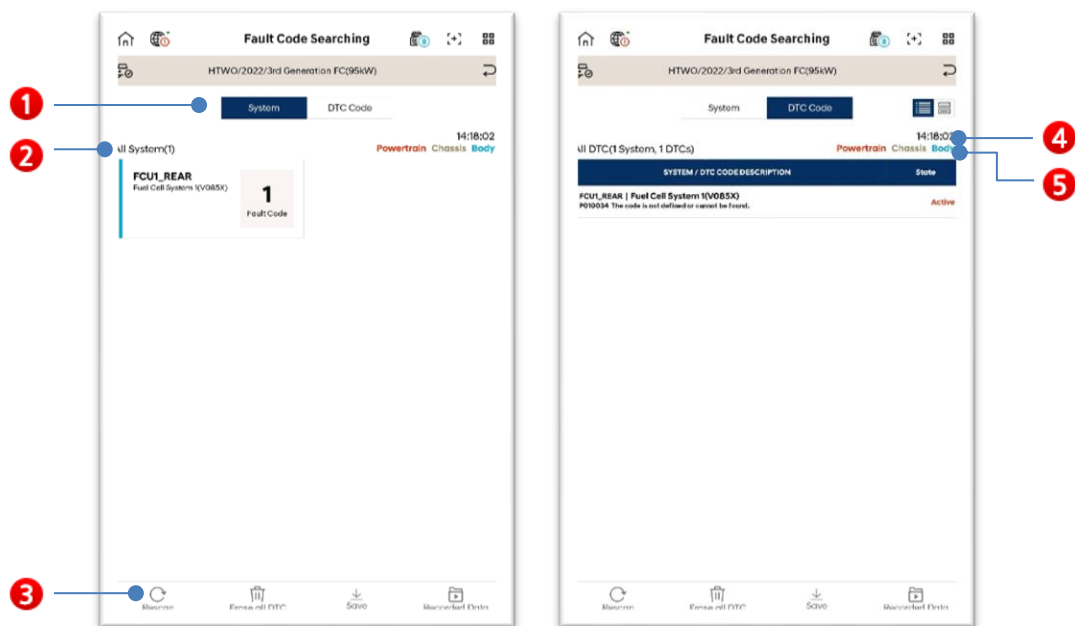

1	You can configure viewing of list by system/by fault code.
2	You can filter systems and fault codes, and view a desired item.
3	The searched fault code can be researched again or deleted.
4	It shows time consumed for searching the fault code.
5	It shows groups of systems and fault codes (powertrain, chassis, body) through color classification.

## Fault Code Search - System

It shows number of searched fault codes by system.

If you select a system, a detailed screen on the searched fault code appears at the bottom.

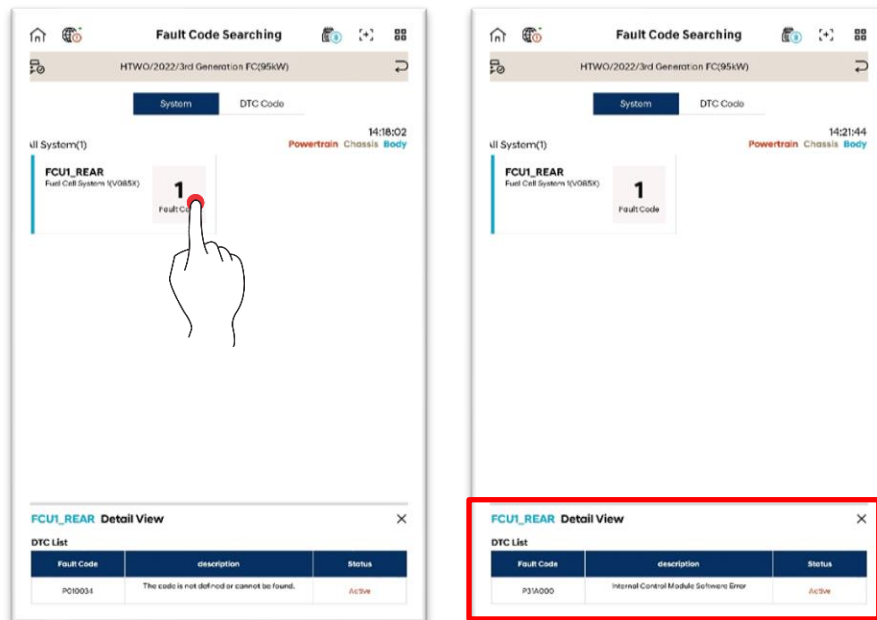

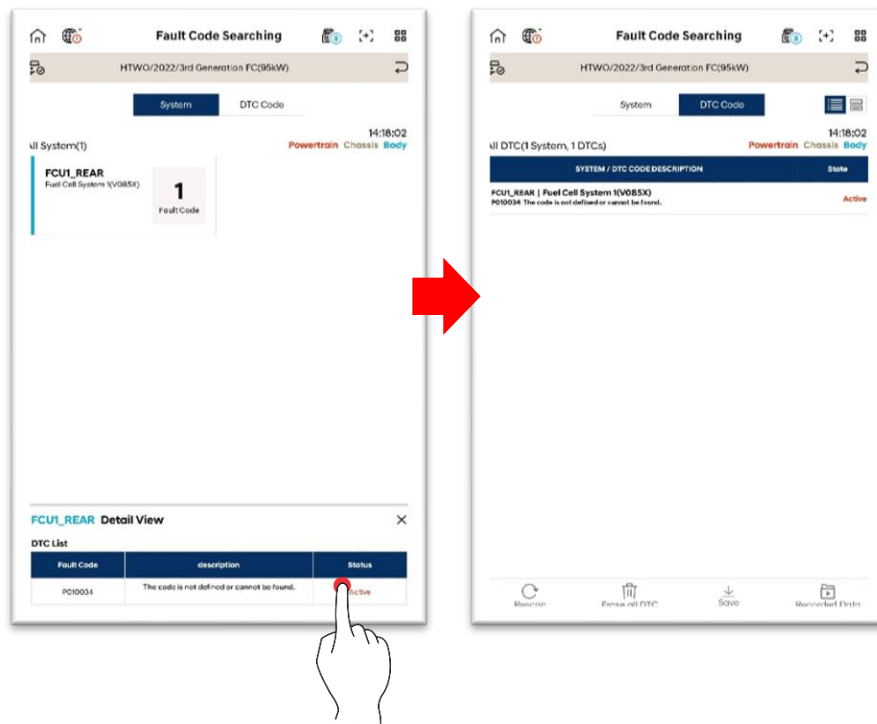

If you select a fault code in the detailed screen, it is switched to 'Fault Code' screen, which provides additional information.



## Status Information

This is status information on the searched results of the fault codes.

### Status Information by Card

 Scanning	Currently performing diagnosis communication with the vehicle.
 Ready	Preparing for diagnosis communication.
<b>0</b> Good	There are no search results for fault codes.
<b>3</b> Fault Code	It indicates number of searched fault codes.
<b>!</b> Communi- cation Failed	Diagnosis communication has failed.
<b>-</b> Not Supported	This system is not supported.

### Fault Code Status Information

<b>Current</b>	Fault codes that are currently recognized as faults in the vehicle.
<b>History</b>	Fault codes that are not currently recognized as faults, although the corresponding faults had occurred in the past.

## Fault Code Search – Fault Code

It shows searched fault codes in list format.

Use ^ v button to receive additional functions on fault codes.

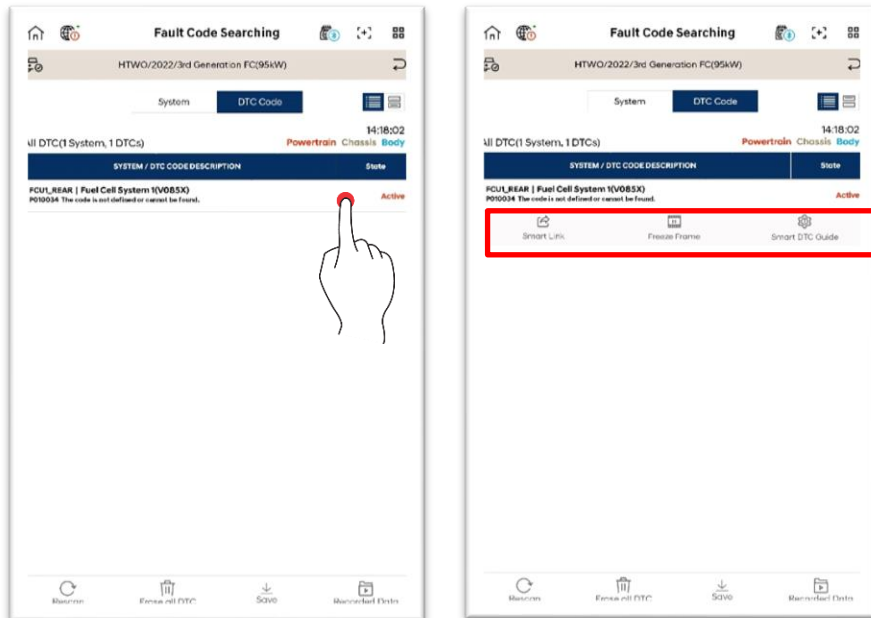

## Freeze Frame

It indicates the sensor data, which is stored in the vehicle at the time when the selected fault code has occurred.

